



3-Way ball valve

THREADED FEMALE OUTLET - 220V ELECTRIC ACTUATOR - FPM ITEM 862



| REFERENCE | DESCRIPTION | Net weight | Volumen (m ³) | Gross weight | Unidades lote |
|-----------|---------------------------------------|------------|---------------------------|--------------|---------------|
| 111V513 | 3 WAY V. ELECT. FEM.THR. L FPM 1" | 0 | 0,01782 | 0 | 1 |
| 111V515 | 3 WAY V. ELECT. FEM.THR. L FPM 1 1/2" | 3,4964 | 0,04460 | 4,1622 | 1 |
| 111V516 | 3 WAY V. ELECT. FEM.THR. L FPM 2" | 4,439 | 0,04460 | 5,1048 | 1 |
| 111V517 | 3 WAY V. ELECT. FEM.THR. L FPM 2 1/2" | 7,3559 | 0,04836 | 8,1994 | 1 |
| 111V553 | 3 WAY V. ELECT. FEM.THR. T FPM 1" | 0 | 0,01782 | 0 | 1 |
| 111V555 | 3 WAY V. ELECT. FEM.THR. T FPM 1 1/2" | 3,4964 | 0,04460 | 4,1622 | 1 |
| 111V556 | 3 WAY V. ELECT. FEM.THR. T FPM 2" | 4,439 | 0,04460 | 5,1048 | 1 |
| 111V557 | 3 WAY V. ELECT. FEM.THR. T FPM 2 1/2" | 7,3559 | 0,04836 | 8,1994 | 1 |

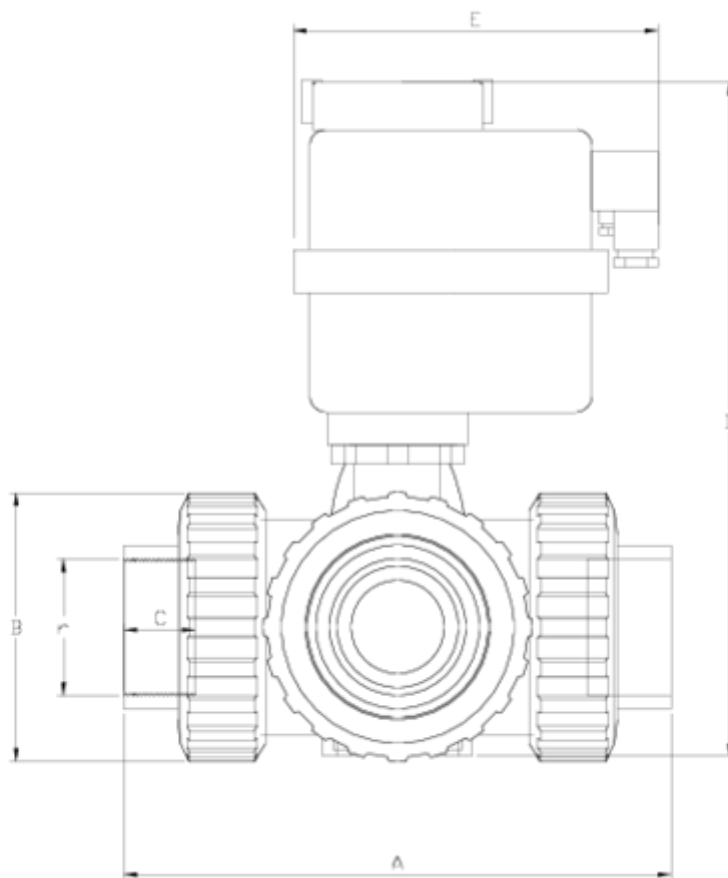

ITEM 862 | THREADED FEMALE OUTLET - 220V ELECTRIC ACTUATOR - FPM

| VITON | r | Actuador | PESO (g) | DN | Modelo | A | B | C | D | E | PN | TIPO ROSCA |
|--------|--------|----------|----------|----|--------|-----|-----|----|-----|-----|------|------------|
| 11V513 | 1" | H10 | 1636 | 25 | L | 162 | 72 | 23 | 220 | 169 | PN16 | BSP |
| 11V515 | 1 1/2" | H20 | 3531 | 40 | L | 210 | 103 | 33 | 279 | 177 | PN16 | BSP |
| 11V516 | 2" | H35 | 4518 | 50 | L | 261 | 120 | 29 | 318 | 177 | PN16 | BSP |
| 11V517 | 2 1/2" | H55 | 7513 | 65 | L | 322 | 150 | 33 | 384 | 177 | PN10 | BSP |
| 11V553 | 1" | H10 | 1632 | 25 | T | 162 | 72 | 23 | 220 | 169 | PN16 | BSP |
| 11V555 | 1 1/2" | H20 | 3521 | 40 | T | 210 | 103 | 33 | 279 | 177 | PN16 | BSP |
| 11V556 | 2" | H35 | 4500 | 50 | T | 261 | 120 | 29 | 318 | 177 | PN16 | BSP |
| 11V557 | 2 1/2" | H55 | 7473 | 65 | T | 322 | 150 | 33 | 384 | 177 | PN10 | BSP |



Product Documents



Product Certificates

Company Certificates

