



Spare parts

BIDIRECTIONAL BALL VALVE MAIN BODY PTFE ITEM 608



REFERENCE	DESCRIPTION	Net weight	Volumen (m ³)	Gross weight	Unidades lote
111D750	PTFE, BIDIRECTION BALL VALVE 20 BODY	0,1144	0,02244	3,921	30
111D751	PTFE, BIDIRECTION BALL VALVE 25 BODY	0,1126	0,01553	2,582	20
111D752	PTFE, BIDIRECTION BALL VALVE 32 BODY	0,2179	0,01553	6,8637	30
111D753	PTFE, BIDIRECTION BALL VALVE 40 BODY	0,3467	0,04117	1,234	14
111D754	PTFE, BIDIRECTION BALL VALVE 50 BODY	0,425	0,02243	6,8627	15
111D755	PTFE, BIDIRECTION BALL VALVE 63 BODY	0,858917	0,02243	10,7981	12
111D756	PTFE, BIDIRECTION BALL VALVE BODY 75	1,74665	0,01553	3,82	2
111D757	CUERPO V.E. BIDIRECCIONAL 90 PTFE	2,4186	0,02243	5,3249	2

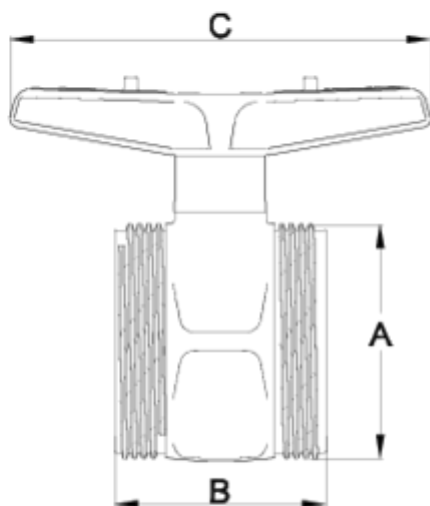

ITEM 608 | BIDIRECTIONAL BALL VALVE MAIN BODY PTFE

CÓDIGO	f	PESO (g)	DN	A	B	C	PN	MEDIDA
11D750	20	83	15	42	44	73	PN16	MÉTRICO
11D751	25	101	20	47	49	73	PN16	MÉTRICO
11D752	32	199	25	57	66	110	PN16	MÉTRICO
11D753	40	324	32	71	71	120	PN16	MÉTRICO
11D754	50	422	40	83	75	120	PN16	MÉTRICO
11D755	63	700	50	98	89	178	PN16	MÉTRICO
11D756	75	1495	65	127	119	260	PN10	MÉTRICO



Pol. Ind. Plá Vallonga,
c/ Agua, 28
03006 ALICANTE (España)



+34 965 11 42 82



+34 965 11 48 62



tecnicocomercial@hidroten.es



Technical &
Commercial Service
+ 34 966 105 888



www.hidroten.es



Product Documents



Product Certificates

Company Certificates

