



'Compact' ball valves

Elbow valve male threaded

PTFE

ITEM 885

REFERENCE	DESCRIPTION	Net weight	Volumen (m ³)	Gross weight	Unidades lote
111C080	PPGF 90° ELBOW VALV. M/THR.-M/THR. 1/2"-1/2"	0,13263	0,00892	2,89	20
111C081	PPGF 90° ELBOW VALV. M/THR.-M/THR. 1/2"-3/4"	0,13138	0,00892	2,865	20
111C082	PPGF 90° ELBOW VALV. M/THR.-M/THR. 3/4"-3/4"	0,177007	0,00892	2,88	15
111C083	PPGF 90° ELBOW VALV. M/THR.-M/THR. 3/4"-1"	0,1733	0,00892	2,824	15



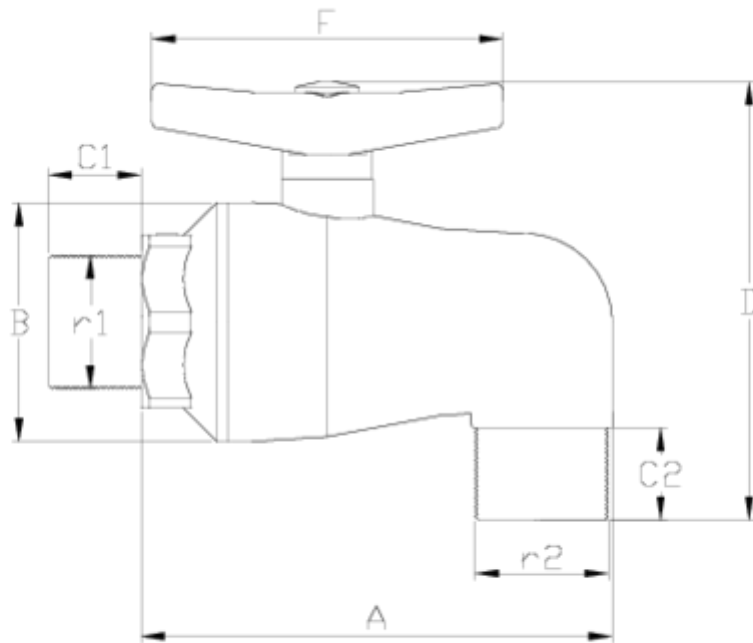

ITEM 885 | Elbow valve male threaded PTFE

CÓDIGO	r1-r2	DN	PESO (g)	A	B	C1	C2	D	F	PN	TIPO ROSCA
11C080	1/2"-1/2"	15	136.9	111	48	14	14	104	80	PN16	BSP
11C081	1/2"-3/4"	15	138	111	48	14	17	106	80	PN16	BSP
11C082	3/4"-3/4"	20	182	120	53	17	17	109	80	PN16	BSP
11C083	3/4"-1"	20	179	120	53	17	19	112	80	PN16	BSP



Product Documents



Product Certificates

Company Certificates

