



'Compact' ball valves

Female - male outlet FPM

ITEM 721

REFERENCE	DESCRIPTION	Net weight	Volumen (m ³)	Gross weight	Unidades lote
111C130	VALVULA COMPACT ROSCA H-M 1/2" FPM	0,106	0,00892	2,24	20
111C131	COMPACT VALVE THR. FEM/MAL 3/4" FPM	0,13963	0,00892	2,98	20
111C132	VALVULA COMPACT ROSCA H-M 1" FPM	0,201	0,01553	3,309	15
111C133	VALVULA COMPACT ROSCA H-M 1 1/4" FPM	0,31882	0,02244	5,27	15
111C134	VALVULA COMPACT ROSCA H-M 1 1/2" FPM	0,45	0,02244	6,68	10
111C135	VALVULA COMPACT ROSCA H-M 2" FPM	0,741	0,02243	5,125	5



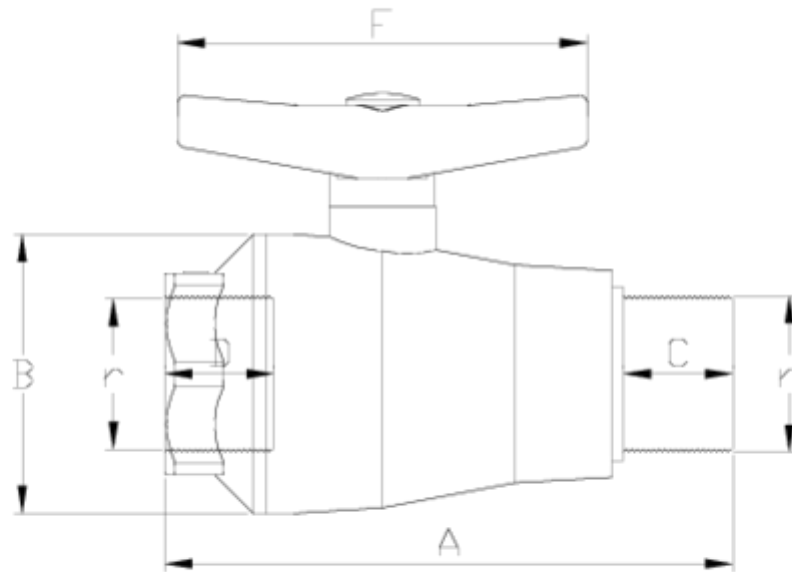

ITEM 721 | Female - male outlet FPM

CÓDIGO	r	DN	PESO (g)	A	B	C	D	F	PN	TIPO ROSCA
11C130	1/2"	15	106	96	48	14	17	80	PN10	BSP
11C131	3/4"	20	137	106	53	17	22	80	PN10	BSP
11C132	1"	25	201	122	60	19	25	101	PN10	BSP
11C133	1 1/4"	32	323	146	74	25	27	130	PN10	BSP
11C134	1 1/2"	40	450	174	87	33	36	130	PN10	BSP
11C135	2"	50	741	202	104	39	39	150	PN10	BSP



Product Documents



Product Certificates

Company Certificates

