



PP compression fittings

90° elbow

ITEM 480

| REFERENCE | DESCRIPTION | Net weight | Volumen (m ³) | Gross weight | Unidades lote |
|-----------|-----------------------|------------|---------------------------|--------------|---------------|
| 112E001 | PP 90° ELBOW 20 GREY | 0,082 | 0,03129 | 7,103 | 80 |
| 112E002 | PP 90° ELBOW 25 GREY | 0,133 | 0,03129 | 7,22 | 50 |
| 112E003 | PP 90° ELBOW 32 GREY | 0,1983 | 0,03648 | 10,5101 | 50 |
| 112E004 | PP 90° ELBOW 40 GREY | 0,3485 | 0,04460 | 11,1849 | 30 |
| 112E005 | PP 90° ELBOW 50 GREY | 0,5448 | 0,04460 | 11,626 | 20 |
| 112E006 | PP 90° ELBOW 63 GREY | 1,024667 | 0,06347 | 16,2 | 15 |
| 112E007 | PP 90° ELBOW 75 GREY | 1,59195 | 0,06150 | 16,84 | 10 |
| 112E008 | PP 90° ELBOW 90 GREY | 2,831225 | 0,04836 | 11,99 | 4 |
| 112E009 | PP 90° ELBOW 110 GREY | 3,934 | 0,04880 | 8,628 | 2 |



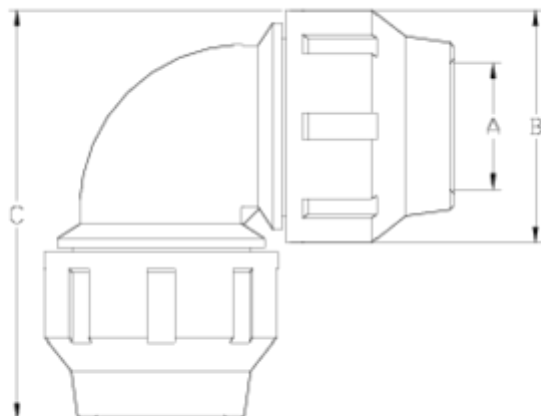

ITEM 480 | 90° elbow

| Código | f tubo | Peso (g) | A | B | C | PN | MEDIDA |
|--------|--------|----------|-----|-----|-----|------|---------|
| 12E001 | 20 | 80 | 21 | 46 | 90 | PN16 | MÉTRICO |
| 12E002 | 25 | 133 | 26 | 55 | 103 | PN16 | MÉTRICO |
| 12E003 | 32 | 196 | 33 | 64 | 119 | PN16 | MÉTRICO |
| 12E004 | 40 | 315 | 42 | 76 | 139 | PN16 | MÉTRICO |
| 12E005 | 50 | 500 | 51 | 91 | 158 | PN16 | MÉTRICO |
| 12E006 | 63 | 891 | 64 | 109 | 193 | PN16 | MÉTRICO |
| 12E007 | 75 | 1586 | 77 | 133 | 242 | PN10 | MÉTRICO |
| 12E008 | 90 | 2633 | 92 | 159 | 291 | PN10 | MÉTRICO |
| 12E009 | 110 | 3934 | 112 | 183 | 320 | PN10 | MÉTRICO |



Product Documents



Product Certificates

Company Certificates

