



Electrofusion fittings/Welding fittings

Electrofusion conical reducing ITEM 165



REFERENCE	DESCRIPTION	Net weight	Volumen (m ³)	Gross weight	Unidades lote
1019131	ELECTROFUSION CONICAL RED. 25-20	0,054915	0,01553	1,425	20
1019132	ELECTROFUSION CONICAL RED. 32-20	0,048	0,01553	1,2	20
1019133	ELECTROFUSION CONICAL RED. 32-25	0,057915	0,01553	1,485	20
1019134	ELECTROFUSION CONICAL RED. 40-32	0,081665	0,01553	1,96	20
1019135	ELECTROFUSION CONICAL RED. 50-32	0,12626	0,00892	1,45	10
1019136	ELECTROFUSION CONICAL RED. 50-40	0,09622	0,01553	1,77	15
1019137	ELECTROFUSION CONICAL RED. 63-32	0,13333	0,01553	1,66	10
1019138	ELECTROFUSION CONICAL RED. 63-40	0,14133	0,01553	1,74	10
1019139	ELECTROFUSION CONICAL RED. 63-50	0,14483	0,01553	1,775	10
1019140	ELECTROFUSION CONICAL RED. 90-63	0,459788	0,02243	4,166	8
1019141	ELECTROFUSION CONICAL REDUCING 110-90	0,549625	0,03129	4,97	8
1019142	ELECTROFUSION CONICAL RED. 125-90	0,717	0,03129	4,875	6
1019143	ELECTROFUSION CONICAL RED. 160-110	1,6749	0,06150	9,295	5
1019144	ELECTROFUSION CONICAL RED. 180-125	2,09	0,06150	9,34	4

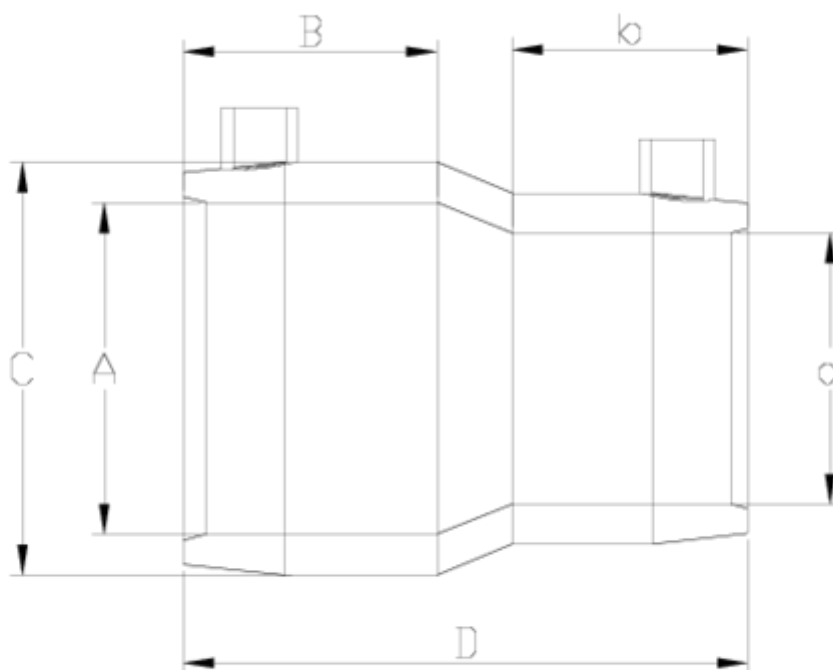

ITEM 165 | Electrofusion conical reducing

Código	f tubo-A-a	Peso (g)	B	b	C	D	PN	MEDIDA
19131	25-20	59	43	38	34	82	PN16	MÉTRICO
19132	32-20	71	43	39	42	90	PN16	MÉTRICO
19133	32-25	60	40	40	44	85	PN16	MÉTRICO
19134	40-32	72	42	43	52	90	PN16	MÉTRICO
19135	50-32	96	47	42	63	98	PN16	MÉTRICO
19136	50-40	136	43	39	66	96	PN16	MÉTRICO
19137	63-32	171	53	42	77	117	PN16	MÉTRICO
19138	63-40	176	55	44	81	117	PN16	MÉTRICO
19139	63-50	189	53	47	77	117	PN16	MÉTRICO
19140	90-63	360	67	63	113	148	PN16	MÉTRICO



ITEM 165 | Electrofusion conical reducing

19141	110-90	657	84	78	137	187	PN16	MÉTRICO
19142	125-90	878	89	76	155	205	PN16	MÉTRICO
19143	160-110	1200	75	72	193	178	PN16	MÉTRICO
19144	180-125	2000	97	70	220	247	PN16	MÉTRICO



Product Documents



Product Certificates

Company Certificates

