



## PP fittings for polyethylene

# Fitting tee compact valve f/ outlet ITEM 897

REFERENCE	DESCRIPTION	Net weight	Volumen (m <sup>3</sup> )	Gross weight	Unidades lote
1012286	FITTING TEE C.V.FIT O.32 1/2"-32	0,3157	0,01553	2,852	8
1012287	FITTING TEE C.V.FIT O.32-25 3/4"-32	0,3298	0,01553	3,126	8
1012292	FITTING TEE C.V.FIT O.63 25 3/4"-63	1,1994	0,04836	10,26	8
1012293	FITTING TEE C.V.FIT O.63-32 1"-63	1,276863	0,04836	10,88	8



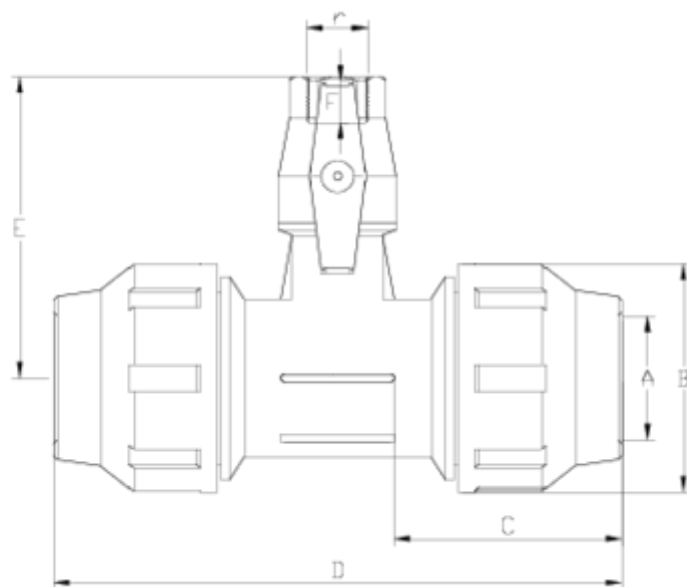

## ITEM 897 | Fitting tee compact valve f/t outlet

Código	A - r - A	Peso (g)	B	C	D	E	F	PN	TIPO ROSCA
12286	32 - 1/2"-32	320	64	70	170	114	17	PN16	BSP
12287	32 - 3/4"-32	345	64	70	170	121	20	PN16	BSP
12292	63 - 3/4"-63	1183	109	113	274	141	20	PN16	BSP
12293	63-1"-63	1266	109	113	274	149	23	PN16	BSP



## Product Documents



## Product Certificates



## Company Certificates

