



'Compact' ball valves

Male threaded elbow - FPM seal ITEM 887

REFERENCE	DESCRIPTION	Net weight	Volumen (m ³)	Gross weight	Unidades lote
111C180	V.COMP.ACOD.RM-RM 1/2"-1/2" FPM	0,133	0,00892	2,833	20
111C181	V.COMP.ACOD.RM-RM 1/2"-3/4" FPM	0,131	0,00892	2,817	20
111C182	V.COMP.ACOD.RM-RM 3/4"-3/4" FPM	0,177	0,00892	2,748	15
111C183	V.COMP.ACOD.RM-RM 3/4"-1" FPM	0,173	0,00892	2,724	15



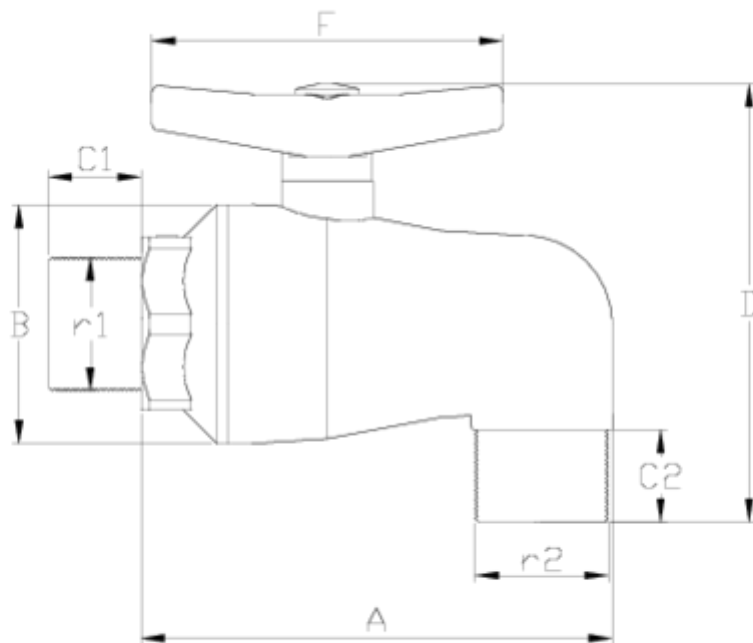

ITEM 887 | Male threaded elbow - FPM seal

CÓDIGO	r1-r2	DN	PESO (g)	A	B	C1	C2	D	F	PN	TIPO ROSCA
11C180	1/2"-1/2"	15	133	111	48	14	14	104	80	PN10	BSP
11C181	1/2"-3/4"	15	131	111	48	14	17	106	80	PN10	BSP
11C182	3/4"-3/4"	20	177	120	53	17	17	109	80	PN10	BSP
11C183	3/4"-1"	20	173	120	53	17	19	112	80	PN10	BSP



Product Documents



Product Certificates

Company Certificates

