



Netvitc System® fluid display

Fluid display, PE outlet

ITEM 090

| REFERENCE | DESCRIPTION | Net weight | Volumen (m ³) | Gross weight | Unidades lote |
|-----------|-----------------------------|------------|---------------------------|--------------|---------------|
| 1018045 | FLUID DISPLAY OUTLET/PE 50 | 0,84 | 0,03129 | 8,854 | 10 |
| 1018046 | FLUID DISPLAY OUTLET/PE 63 | 0,852 | 0,04879 | 9,1 | 10 |
| 1018048 | FLUID DISPLAY OUTLET/PE 90 | 3,61865 | 0,04117 | 15,115 | 4 |
| 1018049 | FLUID DISPLAY OUTLET/PE 110 | 3,1325 | 0,06347 | 13,36 | 4 |
| 1018050 | FLUID DISPLAY OUTLET/PE 125 | 3,553 | 0,04460 | 7,8 | 2 |
| 1018051 | FLUID DISPLAY OUTLET/PE 140 | 5,995 | 0,03129 | 12,55 | 2 |
| 1018052 | FLUID DISPLAY OUTLET/PE 160 | 5,963 | 0,06879 | 12,9 | 2 |
| 1018053 | FLUID DISPLAY OUTLET/PE 200 | 10,0783 | 0,08677 | 11,1 | 1 |
| 1018054 | FLUID DISPLAY OUTLET/PE 225 | 10,555 | 0,06149 | 11,58 | 1 |



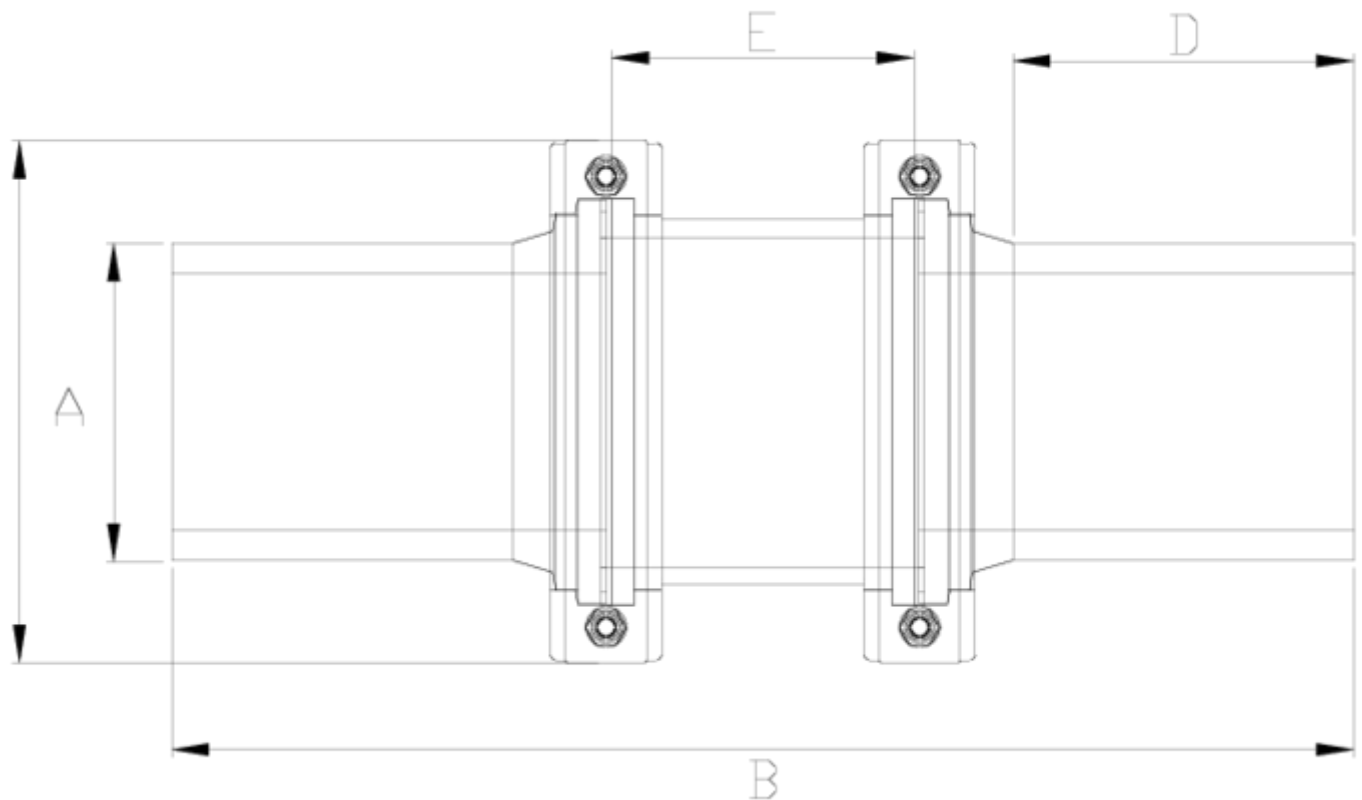

ITEM 090 | Fluid display, PE outlet

| CÓDIGO | A | PESO (g) | BRIDA | B | C | D | E | PN | MEDIDA |
|--------|-----|----------|-------|-----|-----|-----|-----|------|---------|
| 18045 | 50 | 840 | 63 | 318 | 125 | 56 | 70 | PN10 | MÉTRICO |
| 18046 | 63 | 830 | 63 | 308 | 125 | 89 | 70 | PN10 | MÉTRICO |
| 18048 | 90 | 2800 | 125 | 402 | 203 | 100 | 122 | PN10 | MÉTRICO |
| 18049 | 110 | 2920 | 125 | 404 | 203 | 101 | 122 | PN10 | MÉTRICO |
| 18050 | 125 | 3390 | 125 | 466 | 203 | 135 | 122 | PN10 | MÉTRICO |
| 18051 | 140 | 5995 | 160 | 517 | 251 | 98 | 137 | PN10 | MÉTRICO |
| 18052 | 160 | 5965 | 160 | 483 | 251 | 122 | 137 | PN10 | MÉTRICO |
| 18053 | 200 | 11065 | 200 | 620 | 297 | 132 | 210 | PN10 | MÉTRICO |
| 18054 | 225 | 9585 | 200 | 622 | 297 | 243 | 210 | PN10 | MÉTRICO |



Product Documents



Product Certificates

Company Certificates

