



## PP threaded fittings

# 3-inlet manifold M/T

## ITEM 555

REFERENCE	DESCRIPTION	Net weight	Volumen (m <sup>3</sup> )	Gross weight	Unidades lote
1004316	PP MANIFOLD MALE THR. 2"-2"	1,244875	0,04460	5,785	4
1004323	PP MANIFOLD MALE THR. 1"-1"	0,029	0,01553	3,59	10
1004325	PP MANIFOLD MALE THR. 2"-1 1/2"	1,262925	0,02244	5,615	4



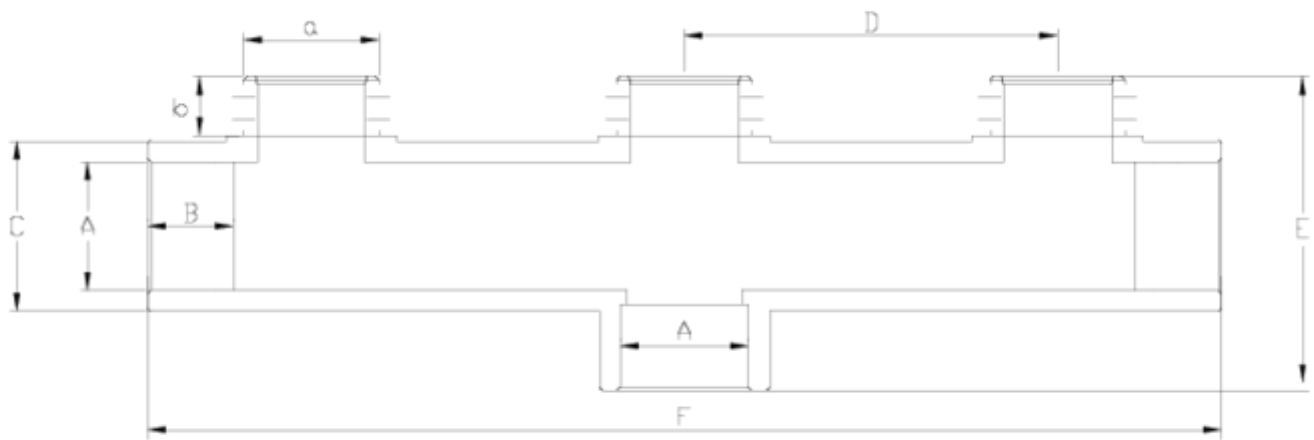

## ITEM 555 | 3-inlet manifold M/T

Código	A-a	Peso (g)	b	B	C	D	E	F	PN	TIPO ROSCA
04322	1" -1"	275	19	22	40	115	85	308	PN10	BSP
04325	2"-1 1/2"	710	21	38	75	165	97	475	PN10	BSP
04316	2"-2"	769	26	38	75	165	102	475	PN10	BSP



## Product Documents



## Product Certificates



## Company Certificates

