



PVC check valves (with spring)

Plain/threaded outlet - EPDM seal ITEM 268



| REFERENCE | DESCRIPTION | Net weight | Volumen (m ³) | Gross weight | Unidades lote |
|-----------|---|------------|---------------------------|--------------|---------------|
| 1016021 | PVC CHECK V. (W/SPR), PLAIN-F.THR.1/2"-20 | 0,134 | 0,01553 | 5,86 | 40 |
| 1016022 | PVC CHECK V. (W/SPR), PLAIN-F.THR.3/4"-25 | 0,177058 | 0,02243 | 7,57 | 40 |
| 1016023 | PVC CHECK V. (W/SPR), PLAIN-F.THR.1"-32 | 0,293743 | 0,02244 | 9,3 | 30 |
| 1016024 | PVC CHECK V. (W/SPR), PLAIN-F.THR.1 1/4"-40 | 0,494 | 0,02244 | 10,415 | 20 |
| 1016025 | PVC CHECK V. (W/SPR), PLAIN-F.THR.1 1/2"-50 | 0,7275 | 0,03129 | 9,059 | 12 |
| 1016026 | PVC CHECK V. (W/SPR), PLAIN-F.THR.2"-63 | 1,179 | 0,03129 | 11,91 | 10 |
| 1016027 | PVC CHECK V. (W/SPR), PLAIN-F.THR.2 1/2"-75 | 2,26 | 0,03129 | 11,156 | 4 |
| 1016028 | PVC CHECK V. (W/SPR), PLAIN-F.THR.3"-90 | 3,5463 | 0,03129 | 9,076 | 2 |

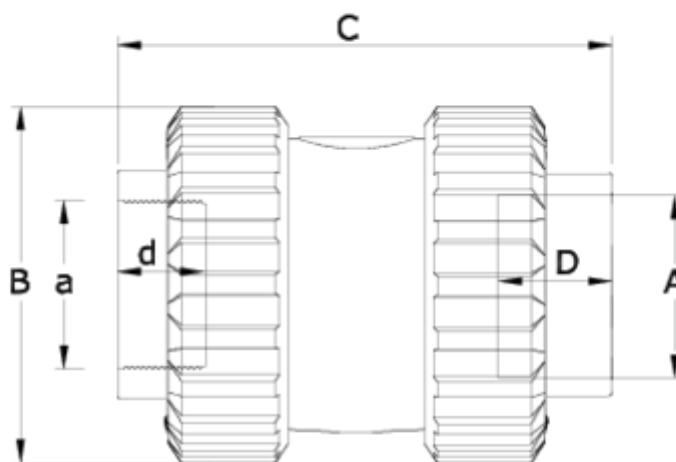

ITEM 268 | Plain/threaded outlet - EPDM seal

| Código EPDM | A | a | Peso | B | C | D | d | PN | TIPO ROSCA |
|-------------|----|--------|------|-----|-----|----|----|------|------------|
| 16021 | 20 | 1/2" | 135 | 52 | 88 | 17 | 16 | PN16 | BSP |
| 16022 | 25 | 3/4" | 177 | 59 | 97 | 19 | 17 | PN16 | BSP |
| 16023 | 32 | 1" | 289 | 69 | 121 | 24 | 21 | PN16 | BSP |
| 16024 | 40 | 1 1/4" | 484 | 85 | 134 | 26 | 23 | PN16 | BSP |
| 16025 | 50 | 1 1/2" | 696 | 99 | 153 | 31 | 31 | PN16 | BSP |
| 16026 | 63 | 2" | 1111 | 116 | 169 | 38 | 38 | PN16 | BSP |
| 16027 | 75 | 2 1/2" | 2649 | 150 | 211 | 44 | 44 | PN10 | BSP |
| 16028 | 90 | 3" | 4258 | 178 | 246 | 51 | 52 | PN10 | BSP |



Product Documents



Product Certificates

Company Certificates

