



## PVC check valves (with spring)

# Thermofusion outlet - FPM seal

## ITEM 508



REFERENCE	DESCRIPTION	Net weight	Volumen (m <sup>3</sup> )	Gross weight	Unidades lote
1016541	PVC CHECK V. (W/SPR), THERMO O.20 FPM	0,14	0,01553	5,84	40
1016542	PVC CHECK V. (W/SPR), THERMO O.25 FPM	0,167	0,01553	6,92	40
1016543	PVC CHECK V. (W/SPR), THERMO O.32 FPM	0,291	0,02244	9,27	30
1016544	PVC CHECK V. (W/SPR), THERMO O.40 FPM	0,443	0,02244	9,4	20
1016545	PVC CHECK V. (W/SPR), THERMO O.50 FPM	0,66	0,02244	8,46	12
1016546	PVC CHECK V. (W/SPR), THERMO O.63 FPM	1,105	0,04717	11,61	10
1016547	PVC CHECK V. (W/SPR), THERMO O.75 FPM	2,21	0,03129	9,46	4
1016548	PVC CHECK V. (W/SPR), THERMO O.90 FPM	3,61	0,02244	7,76	2

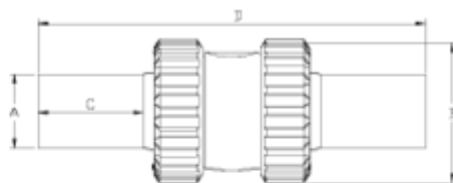

## ITEM 508 | Thermofusion outlet - FPM seal

Código Vitón	A	Peso	B	C	D	PN	MEDIDA
16541	20	148	52	62	218	PN16	MÉTRICO
16542	25	190	59	62	220	PN16	MÉTRICO
16543	32	301	69	46	220	PN16	MÉTRICO
16544	40	493	85	64	259	PN16	MÉTRICO
16545	50	711	99	79	287	PN16	MÉTRICO
16546	63	1169	116	89	274	PN16	MÉTRICO
16547	75	2683	150	91	322	PN10	MÉTRICO
16548	90	4323	178	100	383	PN10	MÉTRICO



## Product Documents



## Product Certificates

## Company Certificates

