



## PVC-U pressure fittings

# Central F/T plain 90° tee

## ITEM 011

REFERENCE	DESCRIPTION	Net weight	Volumen (m <sup>3</sup> )	Gross weight	Unidades lote
1002221	PVC 90° TEE PLAIN/ F. THREAD/PLAIN 20-1/2"	0,0287	0,00892	3,061	100
1002222	PVC 90° TEE PLAIN/ F. THREAD/PLAIN 25-3/4"	0,046433	0,01553	4,97	100
1002223	PVC 90° TEE PLAIN/ F. THREAD/PLAIN 32-1"	0,08239	0,02244	6,255	70
1002224	PVC 90° TEE PLAIN/ F. THREAD/PLAIN 40-1 1/4"	0,157073	0,03682	13,115	80
1002225	PVC 90° TEE PLAIN/ F. THREAD/PLAIN 50-1 1/2"	0,2071	0,04879	14,085	65
1002226	PVC 90° TEE PLAIN/ F. THREAD/PLAIN 63-2"	0,3567	0,06347	14,34	38
1002227	PVC 90° TEE PLAIN/ F. THREAD/PLAIN 75-2 1/2"	0,548235	0,04717	11,65	20
1002228	PVC 90° TEE PLAIN/ F. THREAD/PLAIN 90-3"	1,03	0,04717	13,0453	12
1002229	PVC 90° TEE PLAIN/ F. THREAD/PLAIN 110-4"	1,67385	0,06150	16,8	10



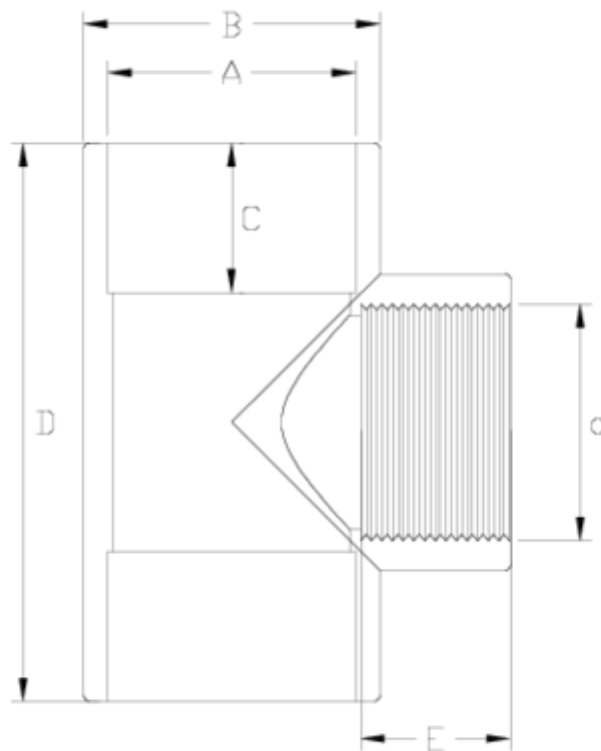

## ITEM 011 | Central F/T plain 90° tee

Código	A-a	Peso (g)	B	C	D	E	PN	ROSCA
02221	20-1/2"	23	27	16	56	16	PN10	BSP
02222	25-3/4"	45	33	19	66	17	PN10	BSP
02223	32-1"	83	41	22	79	21	PN10	BSP
02224	40-1 1/4"	150	50	26	95	23	PN10	BSP
02225	50-1 1/2"	200	61	31	114	24	PN10	BSP
02226	63-2"	327	75	38	141	28	PN10	BSP
02227	75-2 1/2"	540	90	45	166	32	PN10	BSP
02228	90-3"	977	108	51	199	35	PN10	BSP
02229	110-4"	1502	131	61	238	39	PN10	BSP



## Product Documents



## Product Certificates

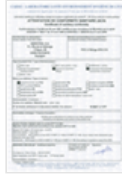

## Company Certificates

