



PVC-U pressure fittings

Plain 45° tee - white range

ITEM 439

| REFERENCE | DESCRIPTION | Net weight | Volumen (m ³) | Gross weight | Unidades lote |
|-----------|------------------------|------------|---------------------------|--------------|---------------|
| 1001540 | PVC 45° TEE 16 - WHITE | 0,021651 | 0,00892 | 3,435 | 150 |
| 1001541 | PVC 45° TEE 20 - WHITE | 0,041076 | 0,01553 | 4,4343 | 100 |
| 1001545 | PVC 45° TEE 50 - WHITE | 0,297 | 0,06347 | 20,06 | 65 |
| 1001546 | PVC 45° TEE 63 - WHITE | 0,5127 | 0,06347 | 20,27 | 38 |



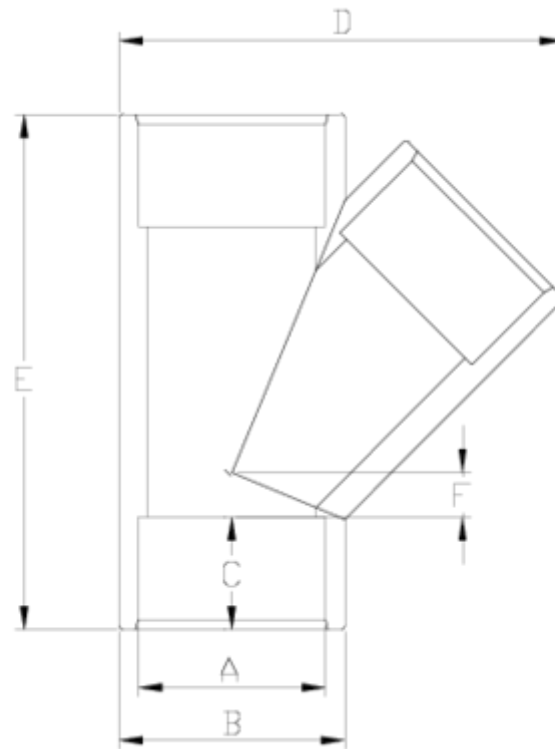

ITEM 439 | Plain 45° tee - white range

| Código | d | Peso (g) | B | C | D | E | F | PN | MEDIDA |
|--------|----|----------|----|----|-----|-----|----|------|---------|
| 01540 | 16 | 26 | 22 | 15 | 48 | 59 | 6 | PN16 | MÉTRICO |
| 01541 | 20 | 34 | 27 | 16 | 55 | 68 | 7 | PN16 | MÉTRICO |
| 01545 | 50 | 300 | 61 | 31 | 121 | 142 | 13 | PN16 | MÉTRICO |
| 01546 | 63 | 475 | 76 | 38 | 150 | 174 | 15 | PN16 | MÉTRICO |



Product Documents



Product Certificates



Company Certificates

