



## PVC-U pressure fittings

# Union, female plain socket - female plain socket

## ITEM 026



REFERENCE	DESCRIPTION	Net weight	Volumen (m <sup>3</sup> )	Gross weight	Unidades lote
1001079	PVC UNION 20	0,035121	0,00473	0,96	24
1001080	PVC UNION 25	0,064288	0,00473	1,66	24
1001081	PVC UNION 32	0,084937	0,00892	3,415	38
1001082	PVC UNION 40	0,154183	0,02244	6,655	40
1001083	PVC UNION 50	0,19292	0,03129	10,219	50
1001084	PVC UNION 63	0,311114	0,04460	11,93	36
1001085	PVC UNION 75	0,553682	0,03648	12,775	22
1001086	PVC UNION 90	0,94225	0,03129	11,88	12
1001087	PVC UNION 110	1,390133	0,03682	8,89	6
1001163	UNION 50-40	0,1986	0,03129	10,5	50
1001166	PVC UNION 63-50	0,329	0,03682	12,4	36

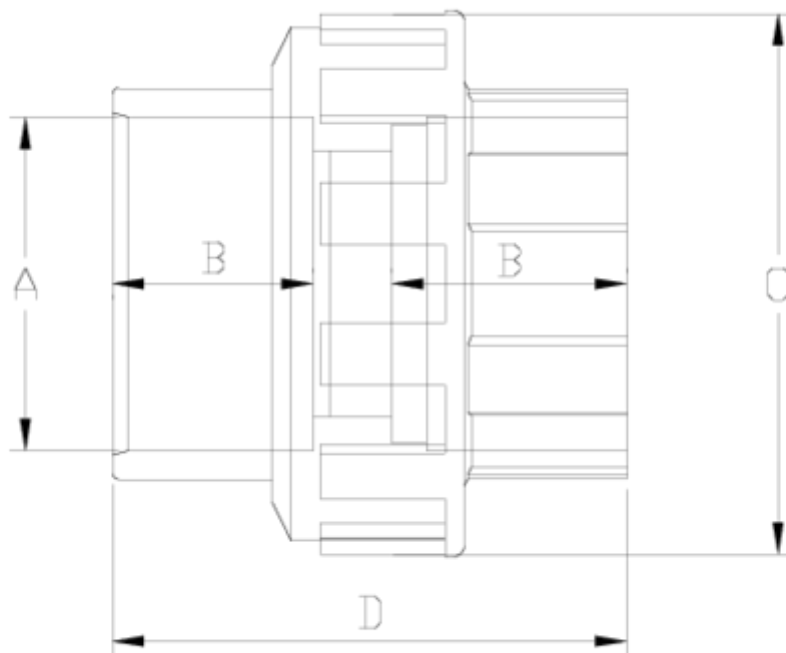

## ITEM 026 | Union, female plain socket - female plain socket

Código	A	Peso (g)	B	C	D	PN	MEDIDA
01079	20	35	16	41	46	PN16	MÉTRICO
01080	25	63	19	51	53	PN16	MÉTRICO
01081	32	85	22	58	59	PN16	MÉTRICO
01082	40	159	26	74	70	PN16	MÉTRICO
01163	50-40	190	31	80	76	PN16	MÉTRICO
01083	50	181	32	81	82	PN16	MÉTRICO
01166	63-50	318	38	98	93	PN16	MÉTRICO
01084	63	317	38	98	99	PN16	MÉTRICO
01085	75	620	44	121	109	PN16	MÉTRICO
01086	90	800	51	142	124	PN16	MÉTRICO



## ITEM 026 | Union, female plain socket - female plain socket

01087

110

1211

61

163

146

PN16

MÉTRICO



## Product Documents



## Product Certificates



## Company Certificates

