



'Basic' ball valves

Thermofusion outlet - FPM - Basic System ITEM 697



REFERENCE	DESCRIPTION	Net weight	Volumen (m ³)	Gross weight	Unidades lote
1011720	FPM BALL VALVE THERMOFUSION OUT. 20	0,155	0,01553	6,44	40
1011721	FPM BALL VALVE THERMOFUSION OUT. 25	0,194	0,03129	8,3	40
1011722	FPM BALL VALVE THERMOFUSION OUT. 32	0,312	0,03129	9,92	30
1011723	FPM BALL VALVE THERMOFUSION OUT. 40	0,538	0,03648	11,32	20
1011724	FPM BALL VALVE THERMOFUSION OUT. 50	0,782	0,03129	12,29	15
1011725	FPM BALL VALVE THERMOFUSION OUT. 63	1,218	0,03682	12,83	10
1011726	FPM BALL VALVE THERMOFUSION OUT. 75	2,64	0,04717	11,12	4
1011727	FPM BALL VALVE THERMOFUSION OUT. 90	4,21	0,04717	9,18	2
1011728	FPM BALL VALVE THERMOFUSION OUT. 110	6,07	0,04460	12,98	2

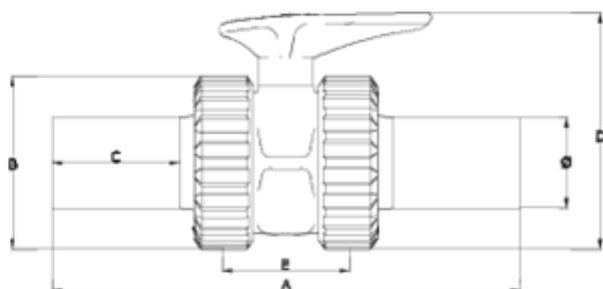

ITEM 697 | Thermofusion outlet - FPM - Basic System

CÓDIGO	ø	PESO (g)	DN	A	B	C	D	E	PN	MEDIDA
11720	20	155	15	215	52	65	78	47	PN16	MÉTRICO
11721	25	194	20	222	59	62	84	51	PN16	MÉTRICO
11722	32	312	25	221	70	45	97	66	PN16	MÉTRICO
11723	40	538	32	260	84	63	128	72	PN16	MÉTRICO
11724	50	782	40	287	99	79	142	77	PN16	MÉTRICO
11725	63	1218	50	328	121	89	165	90	PN16	MÉTRICO
11726	75	2640	65	366	151	95	222	121	PN10	MÉTRICO
11727	90	4210	80	397	175	97	244	141	PN10	MÉTRICO
11728	110	6070	100	435	210	102	307	155	PN10	MÉTRICO



Product Documents



Product Certificates

Company Certificates

